

5004 Series Modular Jack

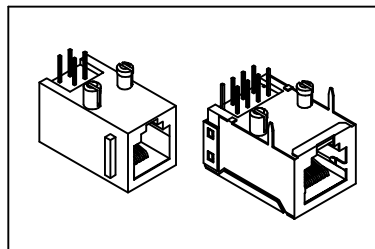

Features:

- * UL recognized, CSA listed.
- * 50μ gold meets FCC 68 requirements.
- * Available in 4, 6, 8, 10 position housing.
- * Industry compatible profiles and foot prints.
- * Available in selective loading.
- * Contact pre-loaded and self aligned.

Material:

Housing: 30% Glass filled PBT UL94V-0.
 Contacts: Phosphor Bronze.
 Shield: 0.25mm Bass, Nickel plated.
 Plating: Selective Gold plated on contact area over Nickel.

Electrical Characteristics:

Current Rating: 2 AMP.
 Insulator Resistance: 5000MΩmin. at DC 500V.
 Contact Resistance: 30mΩmax. at DC 100mA.
 Operating Temperature: -55°C ~ +105°C.
 Capacitance: 1.5pF max between adjacent contacts.

Mechanical Characteristics:

Durability: 250 cycles.
 Retention Force: 7.7kg between jack & plug.
 Max Total Mating Force: 2 contacts loaded-350g.
 4 contacts loaded-500g.
 6 contacts loaded-750g.
 8 contacts loaded-900g.
 10 contacts loaded-1100g.

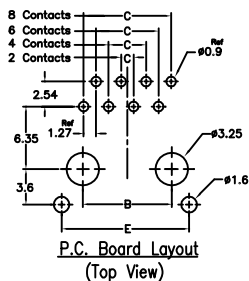
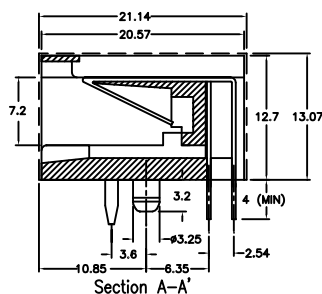
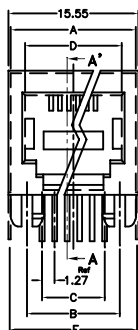

No. of Position	No. of Contacts	Dimensions				
		A	B	C	D	E
4	4	11.20	7.62	3.81	7.70	
6	2	13.20	10.16	1.27	9.80	
6	4	13.20	10.16	3.81	9.80	
6	6	13.20	10.16	6.35	9.80	
8	8	15.20	11.43	8.89	11.80	15.30
10	10	15.20	11.43	11.43	11.80	15.30

Ordering information

8949-D 10 10 /50 S BLK
 Series 10: 10 Position Housing 10: 10 Contacts Loaded 50: 50μ Gold Plated S: Shield BLK: Black
 8: 8 Position Housing 8: 8 Contacts Loaded 30: 30μ Gold Plated (Only for 8, & 10
 6: 6 Position Housing 6: 6 Contacts Loaded 15: 15μ Gold Plated Position)
 4: 4 Position Housing 4: 4 Contacts Loaded 6: 6μ Gold Plated
 2: 2 Contacts Loaded

*Standard for 4P with flange.

**Standard for 6P/8P w/o flange.

***Flange & flangeless is available, pls consult factory.